



THE CITY OF  
**DAVENPORT**  
IOWA | USA

# FY 2024

## Operating Budget Presentation

January 17, 2023 | Davenport Council Chambers

# TODAY'S AGENDA



1 Fund Accounting & Structures

2 CY 2022 Community Survey

3 FY 2023 Financial Update

4 CY 2023 Workplan

5 Financial Policies

6 FY 2024 Budget Information

7 Schedule & Next Session Overview

# BUDGET PROCESS

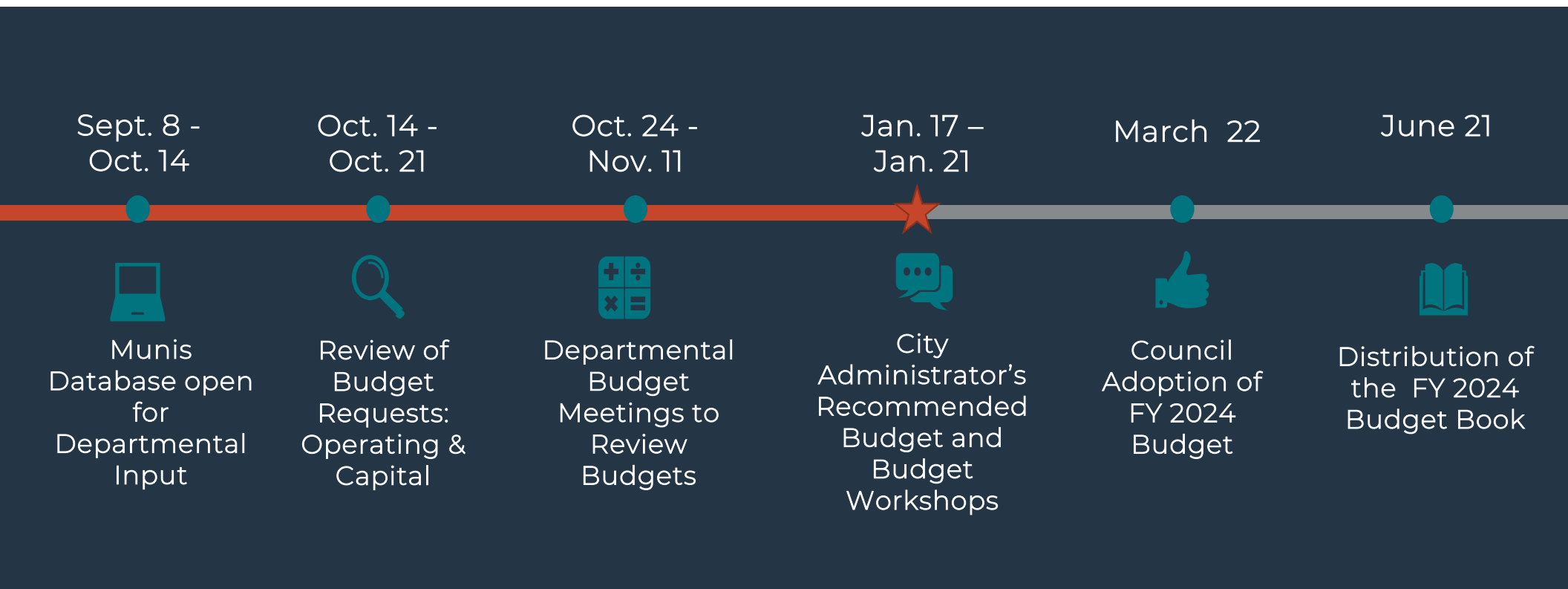

# FY 2024 BUDGET PACKETS



## Overview of FY 2024 Budget Binders:

Overview Memo & Presentations

Budget Summary Reports

Department Business Plans & Detail Pages

CIP Summary Report

CIP Detail Pages

2022 Community Survey

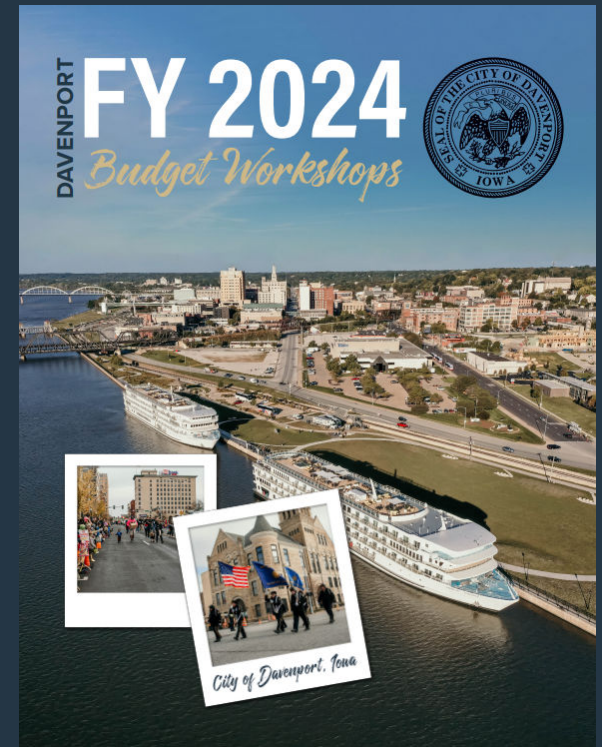





# QUICK REFRESHER

# FUND ACCOUNTING

The purpose of fund accounting is to demonstrate compliance with federal, state, and local laws with our sources of money.



The City has 112 funds.



There are four major fund types:

- Governmental Funds
- Special Revenue Funds
- Internal Service Funds
- Enterprise Funds

# FUND ACCOUNTING

## Governmental Funds

- General Fund
- Hotel/Motel Tax Fund
- Special Library Levy Fund

## Special Revenue Funds

- Road Use Tax Fund
- Local Option Sales Tax Fund
- Grant Funds

## Internal Service Funds

- Risk Fund
- Employee Insurance Fund
- IT Fund

## Enterprise Funds

- Sewer Fund
- Solid Waste Fund
- Golf Fund



# COMMUNITY SURVEY

# COMMUNITY SURVEY 2022

DAVENPORT  
IOWA | USA

## City Services | Citizen's Top 4 Responses City's Top Priorities

- Quality of City streets (82%)
- Quality of neighborhoods (55%)
- Quality of police services (49%)
- City's effort to attract and retain businesses (34%)

## Major Services Recommended for Increased Investment

- Overall quality of City streets
- Overall quality of neighborhoods
- City's effort to attract and retain businesses



## 2022 City of Davenport Community Survey Findings Report

Presented to the City of Davenport,  
Iowa



# COMMUNITY SURVEY 2022

DAVENPORT  
IOWA | USA

## The City's Overall Performance | Rated Highest

- The City as a place to work (68%)
- The City as a place to live (63%)
- The overall quality of services provided by the City (63%)
- The City as a welcoming and inclusive community (55%)

## Community Priorities | Citizens Top 3 Responses

- Public safety (77%)
- City infrastructure (62%)
- Retaining/ attracting jobs (48%)

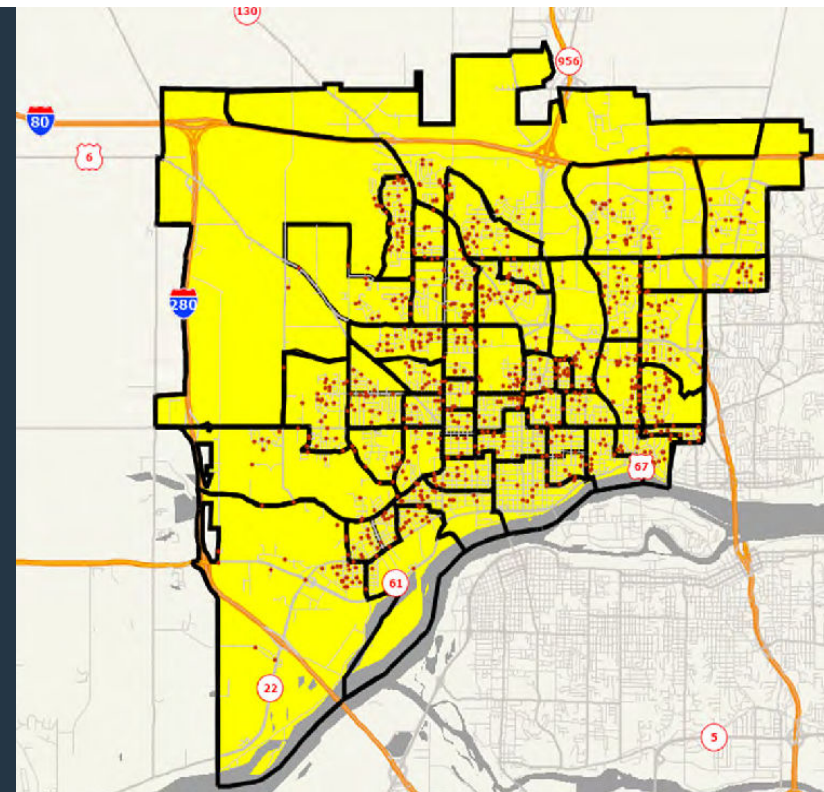

# COMMUNITY SURVEY 2022



2022 City of Davenport Community Survey: Findings Report

## Major Categories of City Services | Rated Highest

- Quality of fire and paramedic services (95%)
- Quality of library services (92%)
- Quality of garbage and recycling collection (84%)
- Quality of City parks, recreation programs, and facilities (75%)

## Q1. Ratings of Major Categories of City Services

by percentage of respondents who rated the item as a 1 to 4 on a 4-point scale (excluding don't knows)

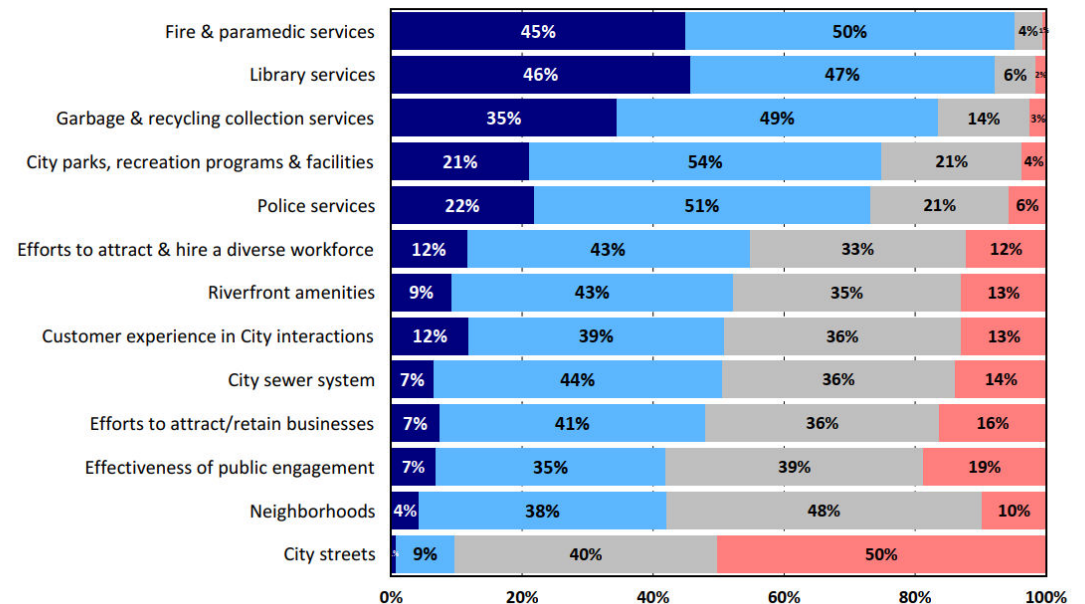

# COMMUNITY SURVEY 2022



## Composite Satisfaction Index - All City Services (2008 to 2022)

derived from the overall satisfaction ratings provided by residents  
Year 2008=100

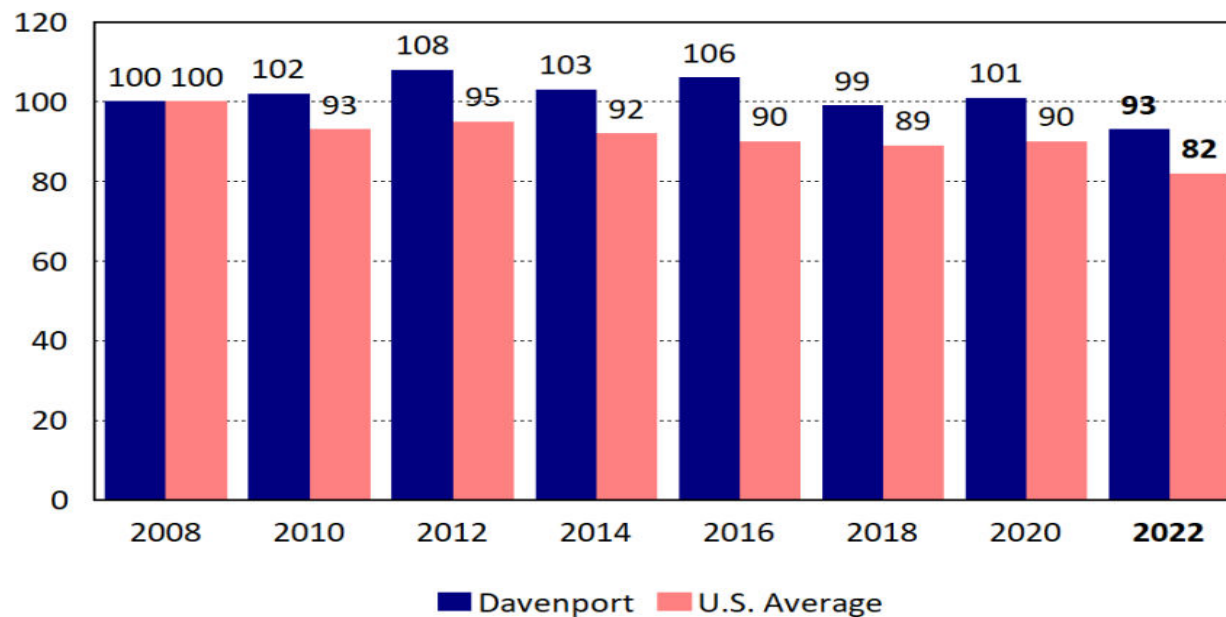



# COMMUNITY SURVEY 2022



## Compared to Other Communities Nationally

- Davenport rated above the U.S. average in 25 of the 40 areas assessed
- Davenport rated significantly higher than the U.S. average in 23 service areas (difference of 5% more)
  - Fire responsiveness to emergency calls for service
  - Police responsiveness to emergency calls for service
  - Library Services
  - Bulky waste collection services
  - Quality of walking and biking trails
  - As a place to live

Service	Davenport	U.S.	Difference	Category
Bulky waste collection services	84.2%	47.3%	36.9%	Solid Waste Services
Recycling collection services	88.5%	56.6%	31.9%	Solid Waste Services
Fire safety education programs	78.3%	50.7%	27.6%	Public Safety Services
Yard waste collection services	82.0%	54.6%	27.4%	Solid Waste Services
Garbage & recycling collection services	83.5%	56.6%	26.9%	Major Categories of City Services
Library services	92.2%	65.6%	26.6%	Major Categories of City Services
Convenience & ease of registration	63.6%	38.6%	25.0%	Parks and Recreation Services
City parks, recreation programs & facilities	74.9%	50.6%	24.3%	Major Categories of City Services
Police responsiveness to emergency calls for service	80.8%	57.6%	23.2%	Public Safety Services
Residential garbage collection services	91.2%	68.6%	22.6%	Solid Waste Services
Quality of outdoor athletic facilities	71.7%	52.7%	19.0%	Parks and Recreation Services
Police services	73.2%	54.6%	18.6%	Major Categories of City Services
Quality/variety of recreational programs/events	62.7%	44.5%	18.2%	Parks and Recreation Services
Fire & paramedic services	95.2%	77.8%	17.4%	Major Categories of City Services
Quality of walking and biking trails	77.5%	62.5%	15.0%	Parks and Recreation Services
Fire responsiveness to emergency calls for service	86.7%	73.1%	13.6%	Public Safety Services
As a place to live	63.1%	49.7%	13.4%	Overall Ratings of the City
Overall quality of services provided by City	62.7%	50.5%	12.2%	Overall Ratings of the City
Customer experience in City interactions	50.8%	40.6%	10.2%	Major Categories of City Services
Quality of swimming facilities and programs	45.8%	35.8%	10.0%	Parks and Recreation Services
As a place to work	67.7%	58.2%	9.5%	Overall Ratings of the City
Value received for City tax dollars and fees	40.2%	33.8%	6.4%	Overall Ratings of the City
Snow removal on major streets	65.0%	59.5%	5.5%	Streets and Infrastructure
Effectiveness of public engagement	42.0%	38.2%	3.8%	Major Categories of City Services
Police Dept. public education efforts	39.2%	38.6%	0.6%	Public Safety Services
Traffic flow on major City streets	43.5%	46.5%	-3.0%	Streets and Infrastructure
Storm drain system operation	47.6%	51.0%	-3.4%	Streets and Infrastructure
As a place to visit	54.4%	58.0%	-3.6%	Overall Ratings of the City
Snow removal in your neighborhood	44.1%	48.1%	-4.0%	Streets and Infrastructure
City sewer system	50.5%	54.8%	-4.3%	Major Categories of City Services
As a place to retire	46.5%	51.7%	-5.2%	Overall Ratings of the City
Overall image of the City	49.6%	55.0%	-5.4%	Overall Ratings of the City
Traffic enforcement	44.5%	50.6%	-6.1%	Public Safety Services
As a place to raise children	54.1%	62.4%	-8.3%	Overall Ratings of the City
Visibility of police in retail areas	36.1%	52.2%	-16.1%	Public Safety Services
Efforts to prevent crime	33.6%	50.4%	-16.8%	Public Safety Services
Visibility of police in your neighborhood	29.1%	55.4%	-26.3%	Public Safety Services
Condition of streets in your neighborhood	21.4%	50.6%	-29.2%	Streets and Infrastructure
City streets	9.7%	41.4%	-31.7%	Major Categories of City Services
Condition of major City streets	13.5%	50.9%	-37.4%	Streets and Infrastructure

# COMMUNITY SURVEY 2022



## Compared to Other Communities Regionally

- Davenport rated above the Plains regional average in 30 of the 40 areas assessed
- Davenport rated significantly higher than the Plains regional average in 24 service areas (difference of 5% more)
  - Fire and paramedic services
  - Police services
  - Garbage & recycling collection services
  - City parks, recreations programs and facilities
  - Customer experience in City interactions
  - As a place to visit

Service	Davenport	Plains Region	Difference	Category
Bulky waste collection services	84.2%	41.3%	42.9%	Solid Waste Services
Recycling collection services	88.5%	49.1%	39.4%	Solid Waste Services
Yard waste collection services	82.0%	45.1%	36.9%	Solid Waste Services
Fire safety education programs	78.3%	43.7%	34.6%	Public Safety Services
Garbage & recycling collection services	83.5%	52.7%	30.8%	Major Categories of City Services
Residential garbage collection services	91.2%	62.4%	28.8%	Solid Waste Services
Library services	92.2%	63.7%	28.5%	Major Categories of City Services
Police responsiveness to emergency calls for service	80.8%	55.6%	25.2%	Public Safety Services
Convenience & ease of registration	63.6%	39.6%	24.0%	Parks and Recreation Services
City parks, recreation programs & facilities	74.9%	53.0%	21.9%	Major Categories of City Services
Quality of outdoor athletic facilities	71.7%	50.9%	20.8%	Parks and Recreation Services
Fire responsiveness to emergency calls for service	86.7%	67.8%	18.9%	Public Safety Services
Fire & paramedic services	95.2%	76.8%	18.4%	Major Categories of City Services
Quality/variety of recreational programs/events	62.7%	46.2%	16.5%	Parks and Recreation Services
Police services	73.2%	57.6%	15.6%	Major Categories of City Services
As a place to work	67.7%	53.4%	14.3%	Overall Ratings of the City
As a place to live	63.1%	49.9%	13.2%	Overall Ratings of the City
Quality of walking and biking trails	77.5%	65.8%	11.7%	Parks and Recreation Services
Overall quality of services provided by City	62.7%	52.6%	10.1%	Overall Ratings of the City
Customer experience in City interactions	50.8%	42.5%	8.3%	Major Categories of City Services
As a place to visit	54.4%	46.2%	8.2%	Overall Ratings of the City
Value received for City tax dollars and fees	40.2%	32.5%	7.7%	Overall Ratings of the City
Quality of swimming facilities and programs	45.8%	40.1%	5.7%	Parks and Recreation Services
Police Dept. public education efforts	39.2%	33.9%	5.3%	Public Safety Services
City sewer system	50.5%	45.8%	4.7%	Major Categories of City Services
Effectiveness of public engagement	42.0%	38.1%	3.9%	Major Categories of City Services
Snow removal on major streets	65.0%	62.8%	2.2%	Streets and Infrastructure
Snow removal in your neighborhood	44.1%	43.2%	0.9%	Streets and Infrastructure
As a place to retire	46.5%	46.2%	0.3%	Overall Ratings of the City
Storm drain system operation	47.6%	47.5%	0.1%	Streets and Infrastructure
Overall Image of the City	49.6%	50.7%	-1.1%	Overall Ratings of the City
As a place to raise children	54.1%	58.3%	-4.2%	Overall Ratings of the City
Traffic flow on major City streets	43.5%	50.6%	-7.1%	Streets and Infrastructure
Traffic enforcement	44.5%	56.9%	-12.4%	Public Safety Services
Visibility of police in retail areas	36.1%	49.7%	-13.6%	Public Safety Services
Efforts to prevent crime	33.6%	52.9%	-19.3%	Public Safety Services
Condition of streets in your neighborhood	21.4%	45.6%	-24.2%	Streets and Infrastructure
City streets	9.7%	35.9%	-26.2%	Major Categories of City Services
Condition of major City streets	13.5%	41.7%	-28.2%	Streets and Infrastructure
Visibility of police in your neighborhood	29.1%	61.0%	-31.9%	Public Safety Services

# COMMUNITY SURVEY 2022



## Q21. Have you called, emailed or visited the City with a question, problem, or comment during the past year?

by percentage of respondents

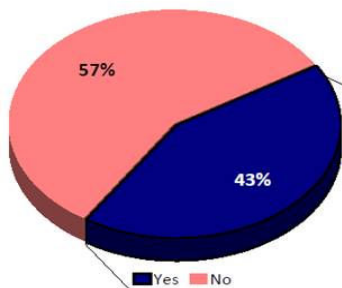

### Q21b. Agreement With Statements About Customer Service Received from Most Recently Contacted Dept.

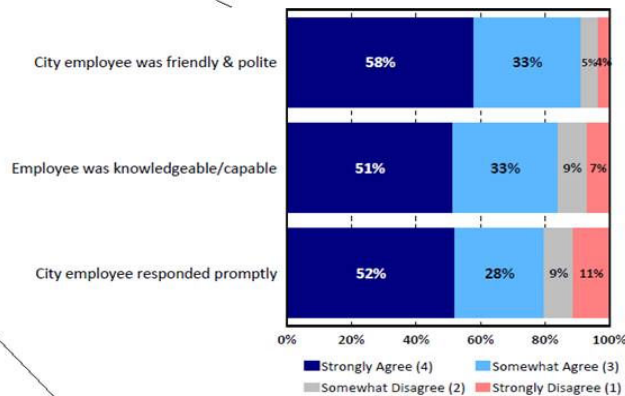

## Trends: Agreement With Statements About Customer Service Received 2008 to 2022

by percentage of respondents who rated the item as a 3 or 4 on a 4-point scale (excluding don't knows)

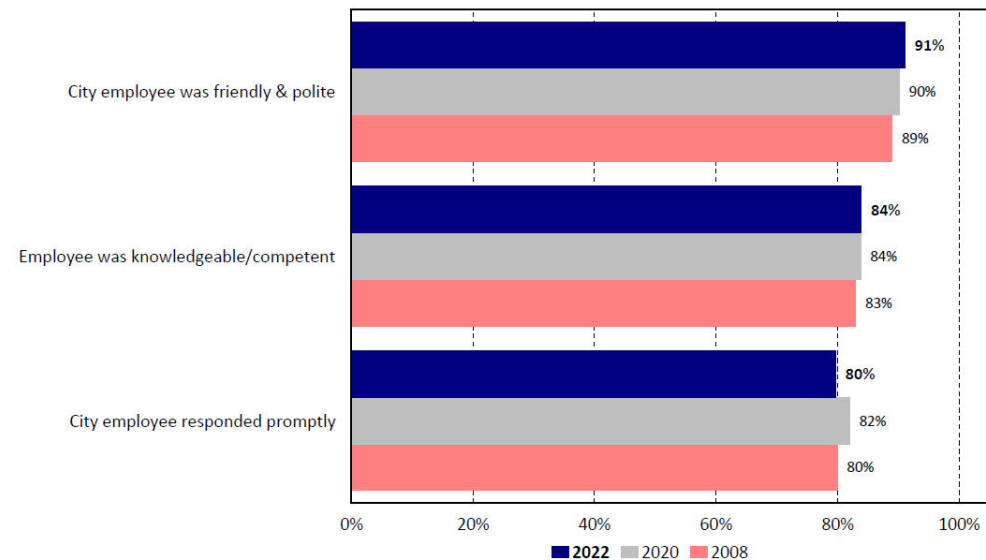





# FY 2023 UPDATE

# FY 2023 BUDGET



General Fund operating departments are currently at, or below, expected spending levels as of the end of November 2022.

With 41.7% of the year completed, 39.2% of overall budgeted expenditures have been spent.

Department	Budget	YTD	%
City Council	336,673	150,915	44.8%
Mayor	129,792	47,695	36.7%
Finance	1,595,963	657,046	41.2%
Administration	897,387	331,139	36.9%
IT	-	(48,455)	-
HR	818,719	270,493	33.0%
CED	646,002	246,644	38.2%
Civil Rights	392,806	123,067	31.3%
DNSD	2,163,497	799,377	36.9%
Public Works	3,320,965	1,523,442	45.9%
Police	20,008,361	7,682,632	38.4%
Fire	13,738,702	5,435,806	39.6%
Parks & Rec	4,623,693	1,814,627	39.2%
Library	2,720,232	1,106,276	40.7%
<b>Total</b>	<b>51,392,792</b>	<b>20,140,706</b>	<b>39.2</b>

# FY 2023 BUDGET



Payroll costs are in line with expected budget levels.

Payroll costs are currently at 36.2%, which is slightly below the expected budget of 37.0%.

Trust & Agency benefits are currently at 38.3% which is below the expected budget of 39.5%.

Benefit Summary			
Benefit	Budget	YTD	%
FICA	1,500,569	557,972	37.2%
IPERS	1,396,818	469,293	33.6%
Employee Insurance	11,280,709	4,655,976	41.3%
MFPRSI	6,050,380	2,130,674	35.2%
Deferred Compensation	21,216	-	0.0%
RHSP	876,409	326,044	37.2%
Fit Pay	131,000	-	0.0%
Total	21,257,101	4,139,958	38.3%

# FY 2023 HEALTHCARE COSTS



Claims and expenditures are currently trending in line with the original budget of \$15.5M

- YTD | \$5.3M as of the end of November
- Current year-end projection | \$12,976,474

As of the end of November, claims for FY 2023 are 14.3% lower than claims in FY 2022

- No claims currently hitting stop loss levels (\$190K)

FY 2023 monthly average is \$1,066,240



# BUDGET INTRODUCTION



# FY 2024 BUDGET MESSAGE



STABLE CONDITION | The City is in an overall stable and positive financial condition.

PLANNING | The City continues to plan for various budget strategies to address any potential unknowns.

FLEXIBILITY | Prior budget and operating decisions have allowed the City to have greater flexibility during the pandemic and beyond.

GENERAL FUND STABILITY | Strong financial position in the General Fund; 39.7% fund balance (Balanced)

GROWTH | Positive growth in major operating funds; taxable valuation increase of over 2.0% even with a decrease in the multi-residential rollback and commercial property tax structure changes.

CONSERVATIVE BUDGETING | Continues to apply conservative budgeting practices; monitoring trends before incorporating any revenue increases.

# BOND RATINGS CURRENT



Strong overall financial position.

Positive outlook assigned.

Very strong finances & budgetary flexibility.

Strong operating reserves and liquidity relative to the budget.

## Bond Ratings

**S&P Global** **AA**

**MOODY'S** **Aa3**

# FY 2024 BUDGET HIGHLIGHTS



1

Remains mission-aligned and continues the focus on operational pillars, ARPA, and the City Administrator's workplan.

2

Complies with the City Council's policies for all reserve and liquidity targets & financial policies.

3

Maintains the current tax levy rate of \$16.78/\$1,000 taxable value and current service levels.

Remains mission-aligned and continues the focus on the operational pillars, ARPA, and the City Administrator's workplan.

DAVENPORT  
IOWA | USA

ARPA projects underway.

Strategic initiatives added to complement and implement City Council's goals.

[illegible]

# FIRE STATION 3

DAVENPORT  
IOWA | USA





# PUBLIC SAFETY TALENT INVESTMENT

DAVENPORT  
IOWA | USA



**GVI**



**DAVENPORT**  
IOWA | USA





# 21<sup>st</sup> CENTURY POLICING

DAVENPORT  
IOWA | USA



# STREETS & SEWERS



53<sup>rd</sup> | Eastern to Elmore Circle Phase 2

Central Park | Cedar to Lincoln Phase II

Locust | Marquette to Division

Central Park | Brady to Pershing & Farnam  
Intersection

36th | Division to Pacific

Waverly | Lincoln to Schuetzen

W. 43rd | Linwood to Lincoln

54th | Howell to Kelling

Lining and Manhole Rehabilitation Program

Sewer Lateral Repair Program

Contract Sewer Repair Program

Tremont Interceptor Sewer

Duck Creek Interceptor Sewer

Inflow and Infiltration Removal Program



# WPCP FLOOD MITIGATION

DAVENPORT  
IOWA | USA

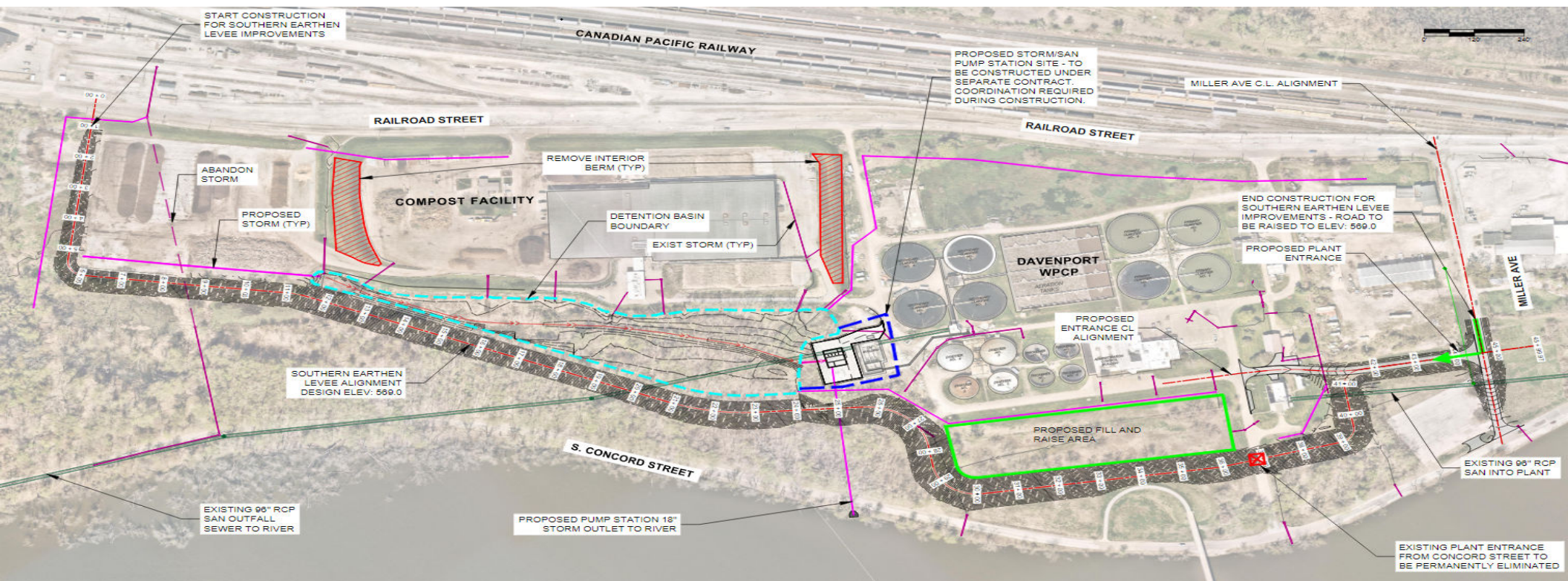



# CP PROJECTS



**DAVENPORT**  
IOWA | USA





# DUCK CREEK SEWER

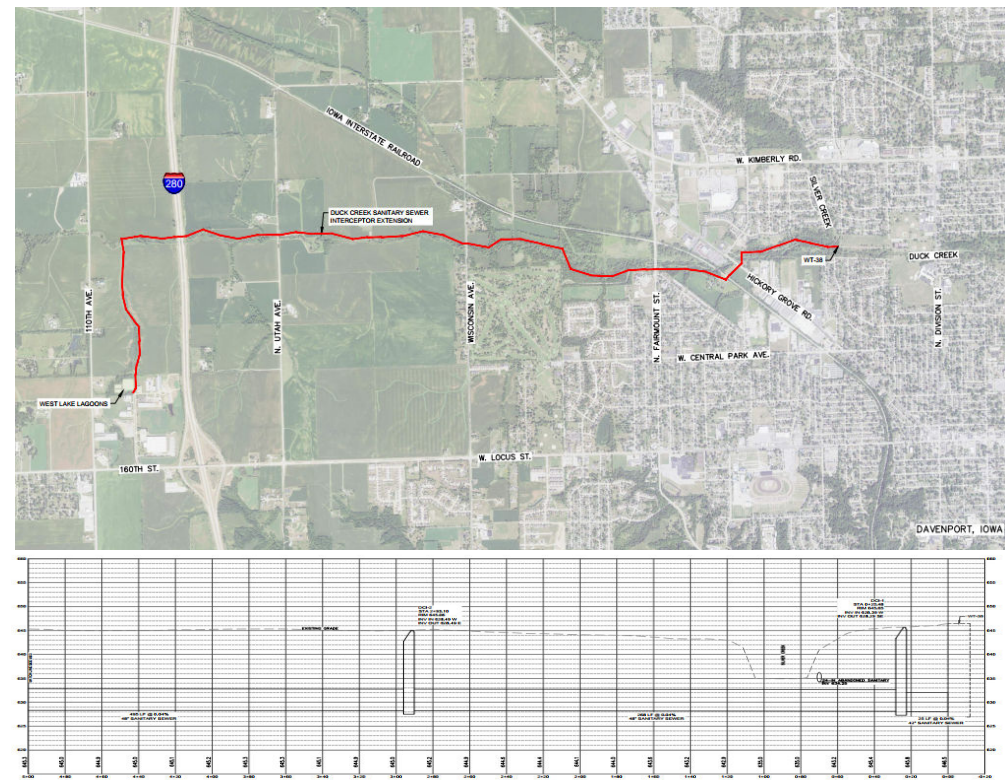
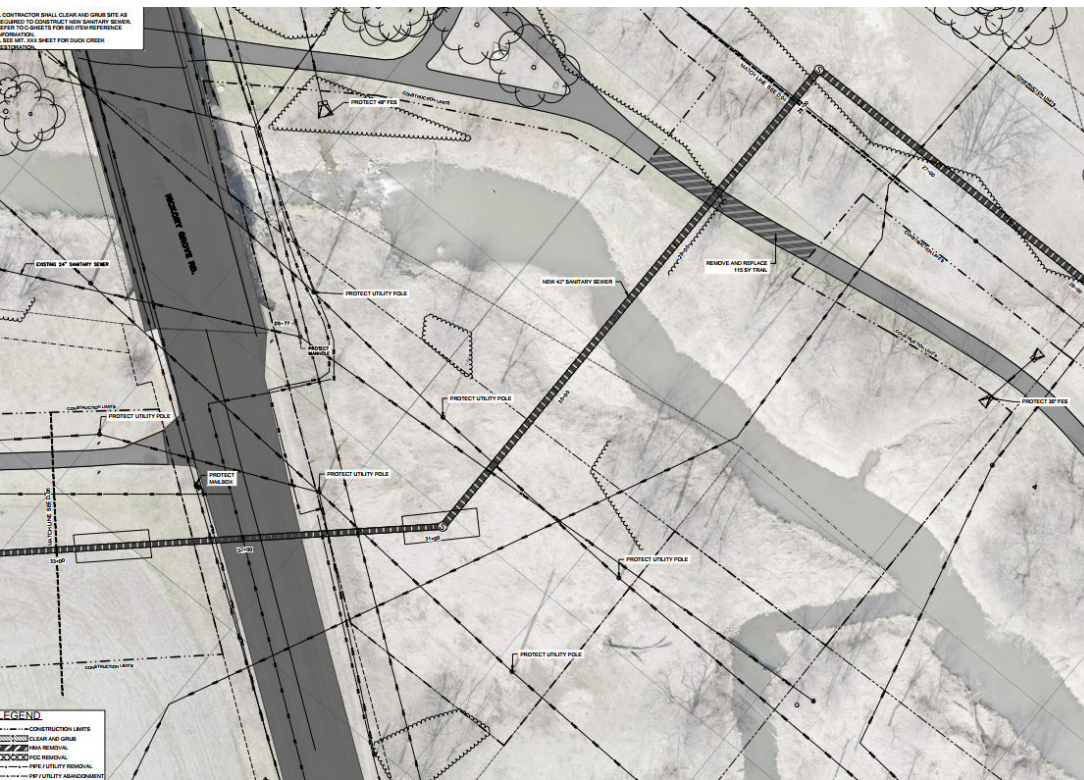



# DREAM, DREAM+, & EXTREME DREAM

DAVENPORT  
IOWA | USA





# FAIRMOUNT COMMUNITY CENTER

DAVENPORT  
IOWA | USA



# ARPA PARKS INVESTMENTS

DAVENPORT  
IOWA | USA





# DESTINATION IOWA EXPERIENCE 9

DAVENPORT  
IOWA | USA





# RIVERCENTER MASTER PLANNING

DAVENPORT  
IOWA | USA

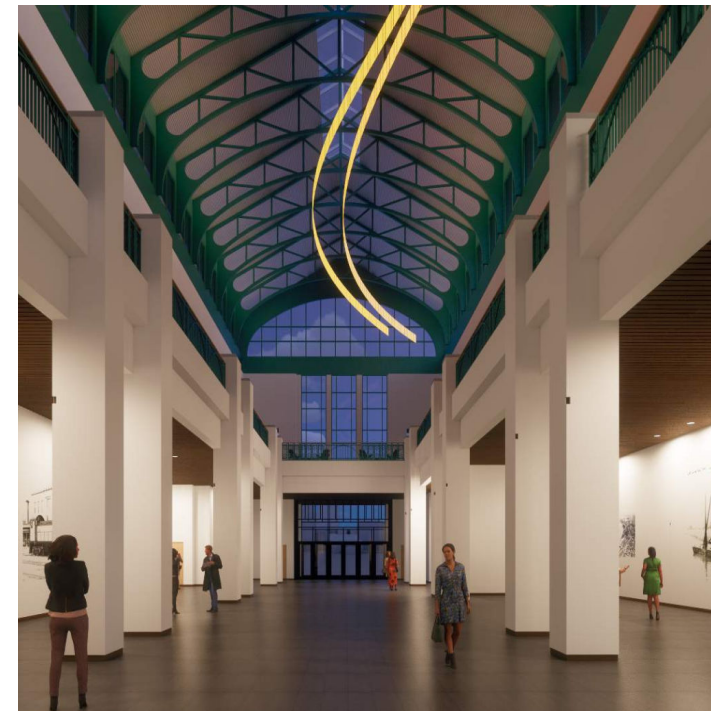
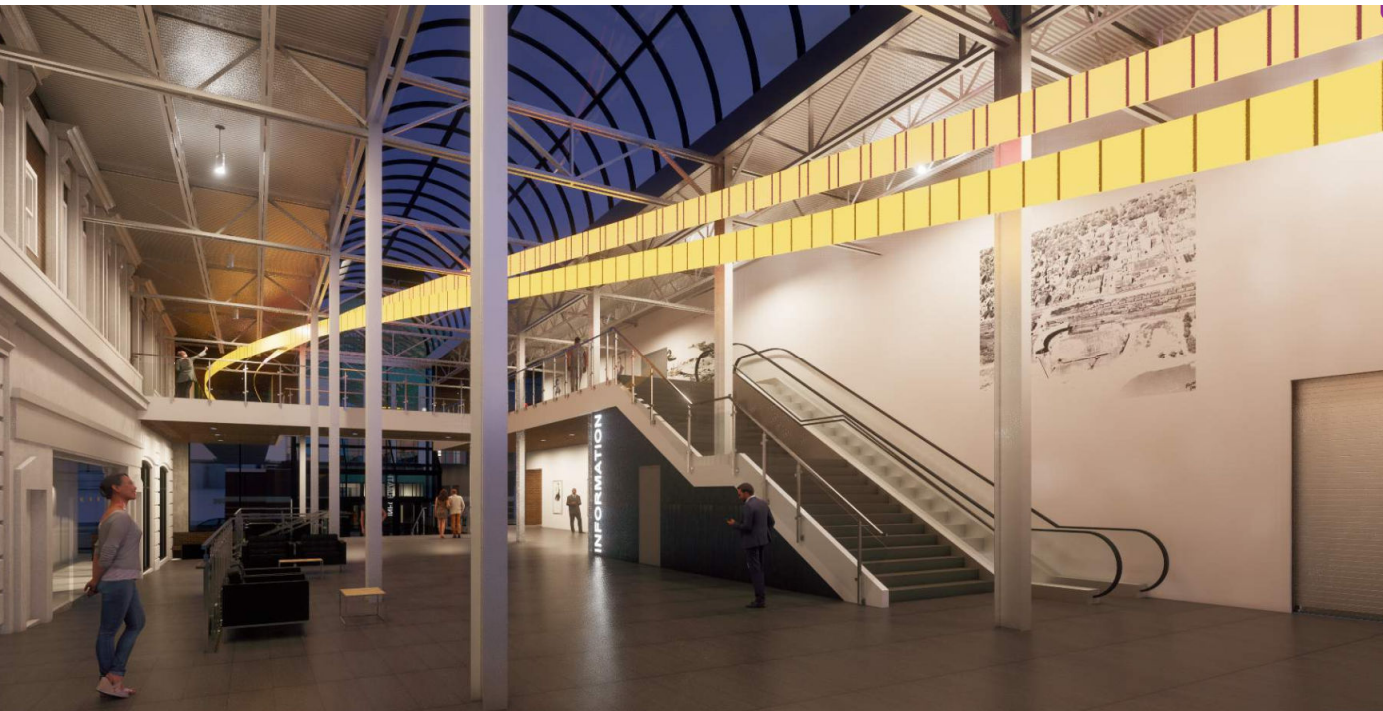

# LONG-RANGE STRATEGIES



River's Edge | *Enterprise Planning*

NorthPark Mall | *Market Study & Analysis*

Annie Wittenmyer Complex | *Capital Evaluation*

Water Pollution Control Plant | *Long-range capital and equipment replacement planning with partner entities*

Complies with the City Council's policies for all reserve and liquidity targets and financial policies.

# FY 2022 SUMMARY



General Fund reserves are at maximum amount of 25.0% (City Council policy is between 17.0%-25.0%).

Unrestricted cash across all funds is at \$187.5M representing a 28.4% increase over prior year.

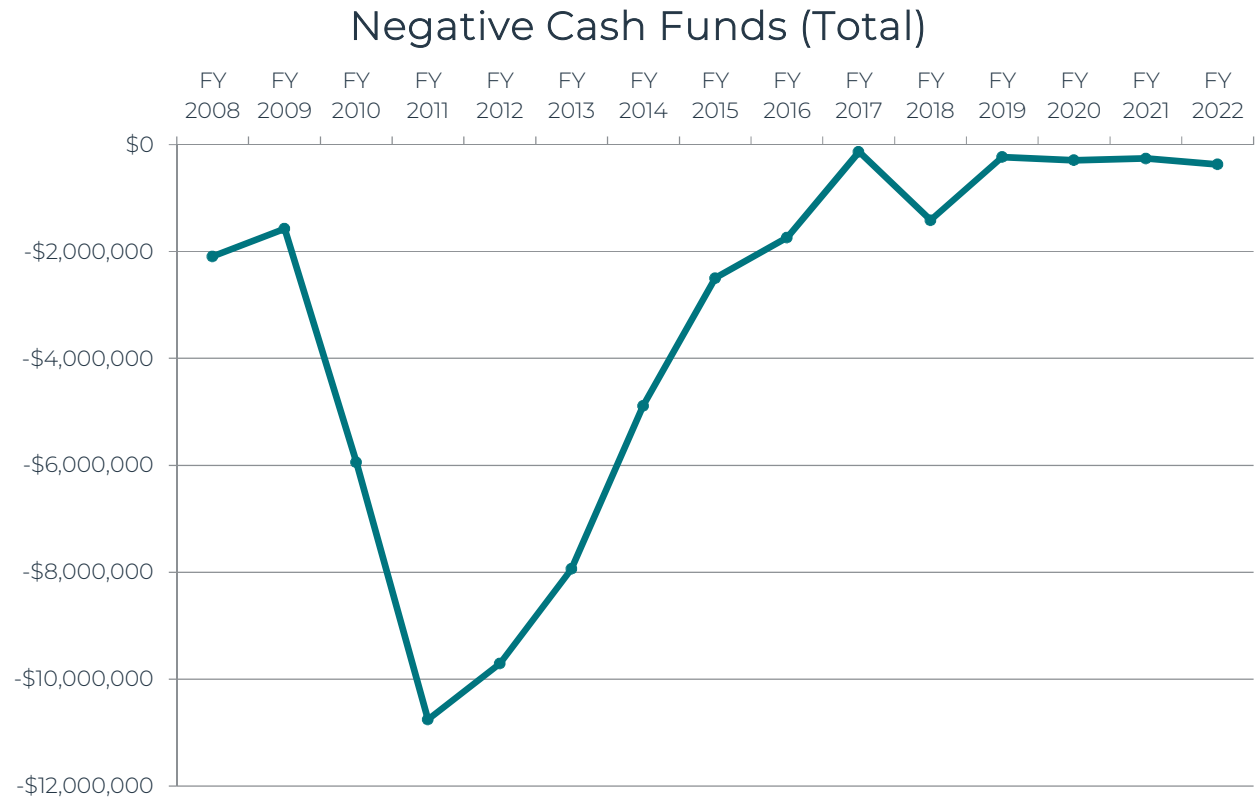



# LIQUIDITY POLICY

## Governmental Type Funds FY 2022

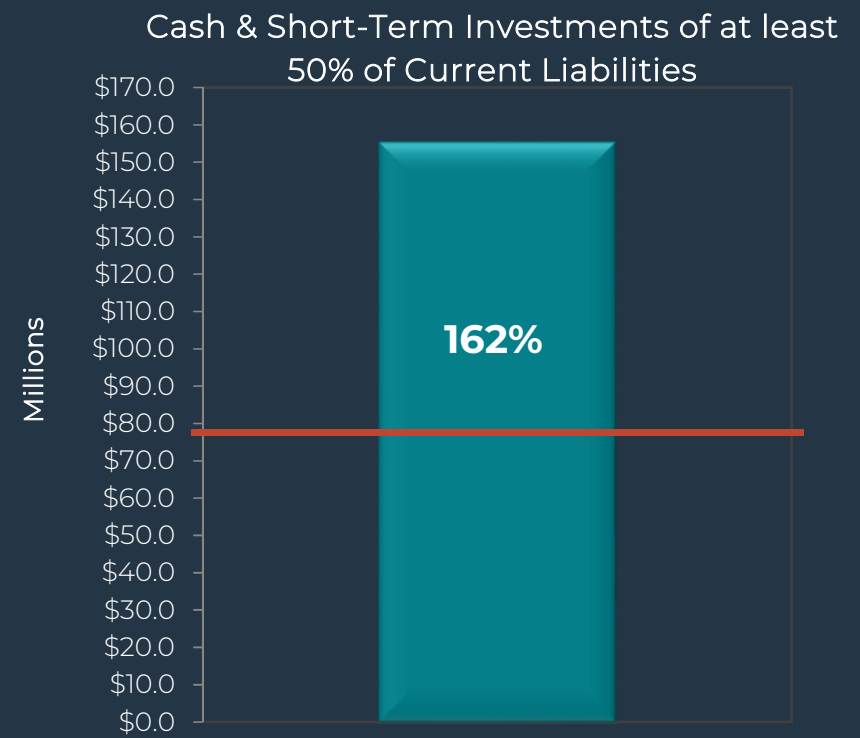
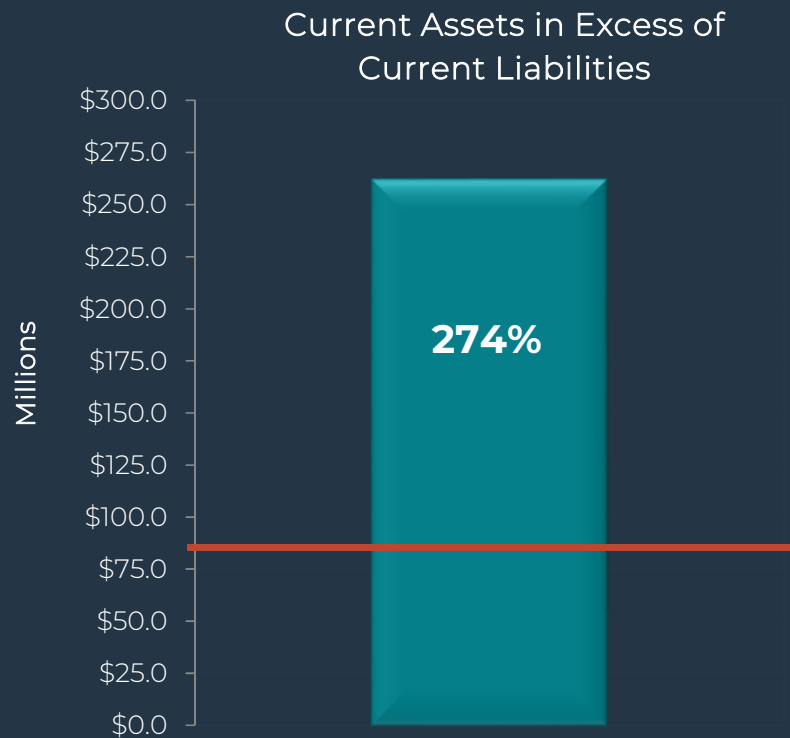

# LIQUIDITY POLICY

## Business Funds FY 2022

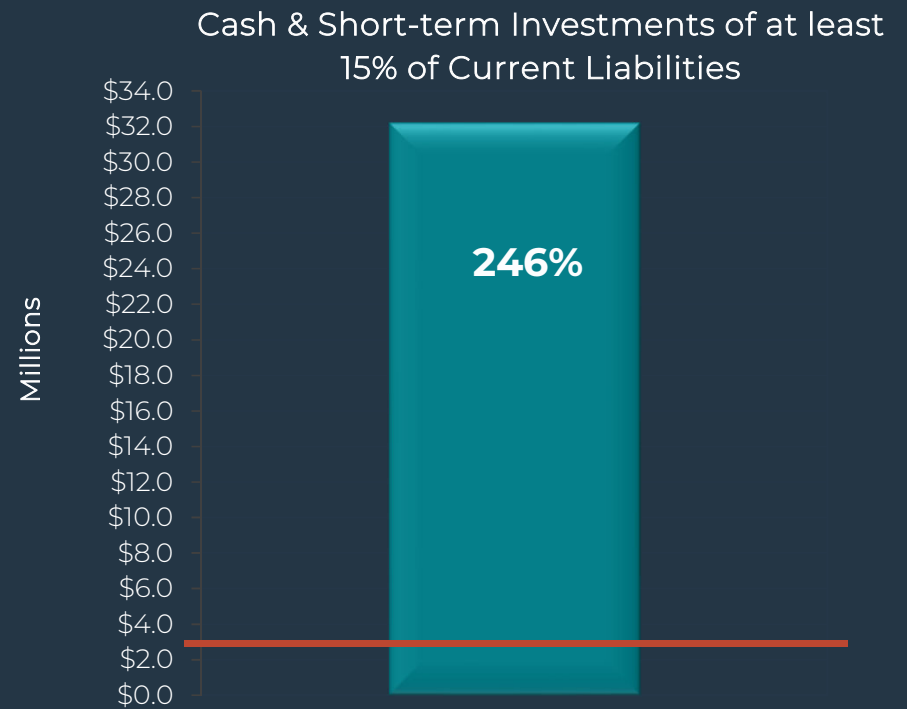
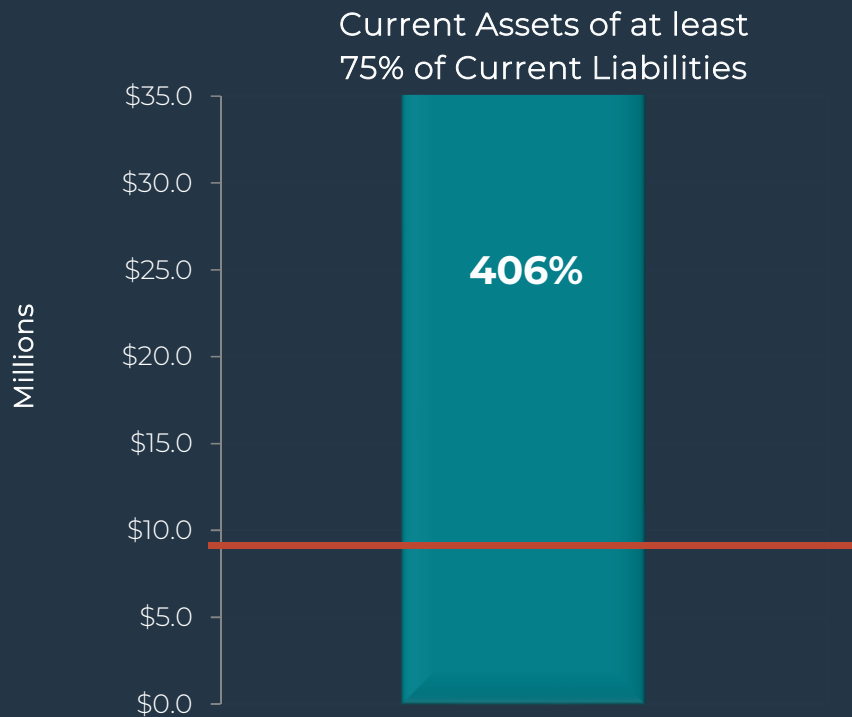

# FY 2022 REVIEW



Fund or Fund Type	June 30, 2021	June 30, 2022	Change	Percentage
Governmental Funds	\$123,807,243 Unrestricted Cash	\$155,338,773 Unrestricted Cash	+\$31,531,530 Unrestricted Cash	+25.47%
General Fund (Unassigned)	\$20,577,570 Fund Balance	\$13,635,434 Fund Balance	-\$6,942,136 Fund Balance	-33.74%
Trust & Agency Fund	\$4,151,220 Fund Balance	\$4,527,244 Fund Balance	+\$376,024 Fund Balance	+9.06%
Employee Insurance Fund	\$11,016,025 Net Position	\$12,860,483 Net Position	+\$1,844,458 Net Position	+16.74%
Risk Fund	-\$3,858,103 Net Position	-\$2,668,345 Net Position	+\$1,189,758 Net Position	+44.59%
Hotel/Motel Tax Fund	\$1,906,284 Fund Balance	\$2,942,949 Fund Balance	+\$1,036,665 Fund Balance	+54.38%
Local Sales Tax Fund	\$11,969,814 Fund Balance	\$15,409,809 Fund Balance	+\$3,439,995 Fund Balance	+28.74%
Sewer Fund (Operations)	\$12,529,988 Cash	\$16,953,244 Cash	+\$4,423,256 Cash	+35.30%

# FY 2022 REVIEW



Fund or Fund Type	June 30, 2021	June 30, 2022	Change	Percentage
Debt Service Fund	\$15,607,600 Cash	\$21,280,742 Cash	+\$5,673,142 Cash	+36.35%
Road Use Tax Fund	\$4,410,688 Fund Balance	\$4,272,305 Fund Balance	-\$138,383 Fund Balance	-3.14%
Clean Water Fund	\$2,307,294 Cash	\$2,543,628 Cash	\$236,334 Cash	+10.24%
Golf Fund	\$22,500 Cash	\$68,636 Cash	+\$46,136 Cash	+205.05%
Airport Fund	\$2,593 Cash	\$8,131 Cash	+\$5,538 Cash	+213.58%
Transit Fund	\$2,892,681 Cash	\$3,252,625 Cash	+\$359,944 Cash	+12.44%
Solid Waste Fund	\$2,030,766 Cash	\$2,436,292 Cash	+\$405,526 Cash	+19.97%
Parking Fund	\$0 Cash	\$77,387 Cash	+\$77,387 Cash	N/A
River's Edge Fund	\$2,641 Cash	\$7,146 Cash	+\$4,505 Cash	+170.58%

# TRUST & AGENCY FUND RESERVES

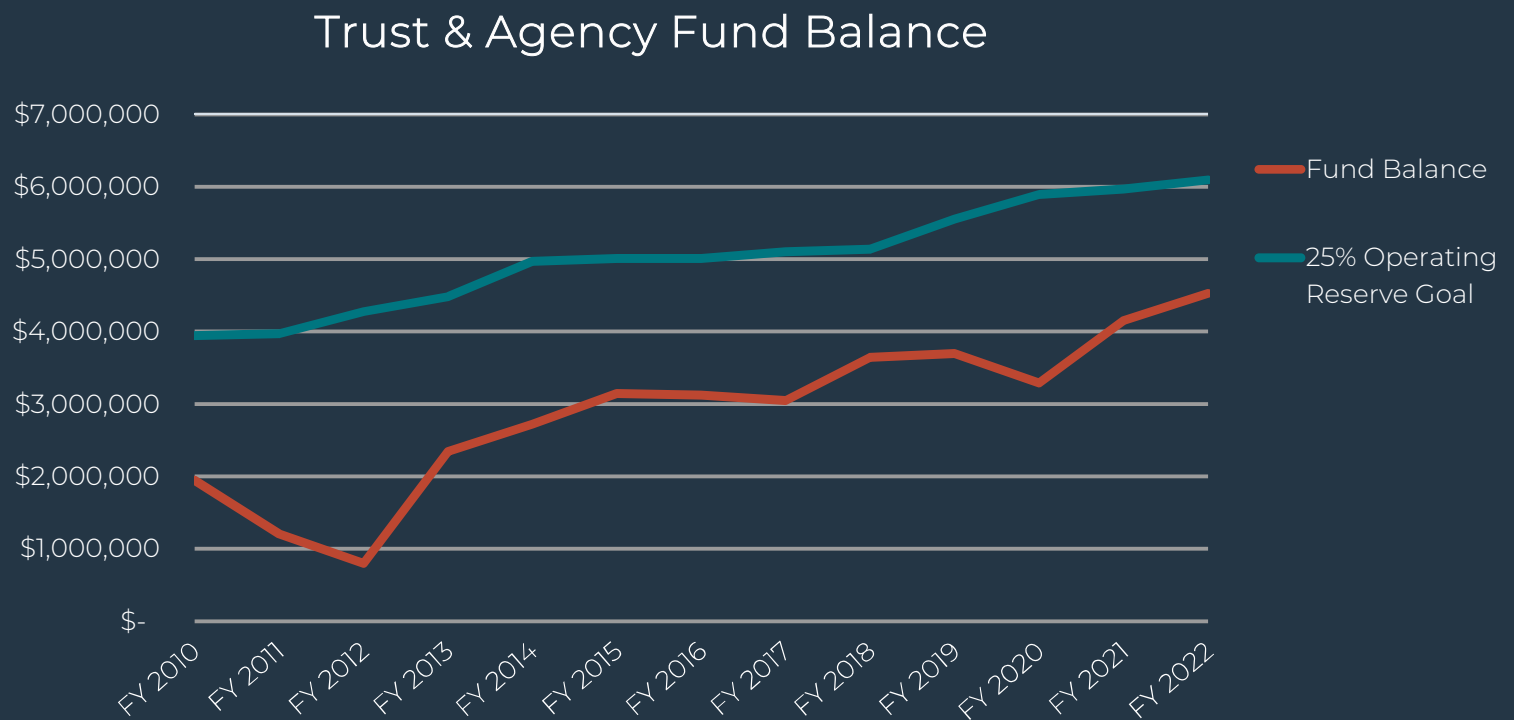



# EMPLOYEE HEALTH FUND NET POSITION

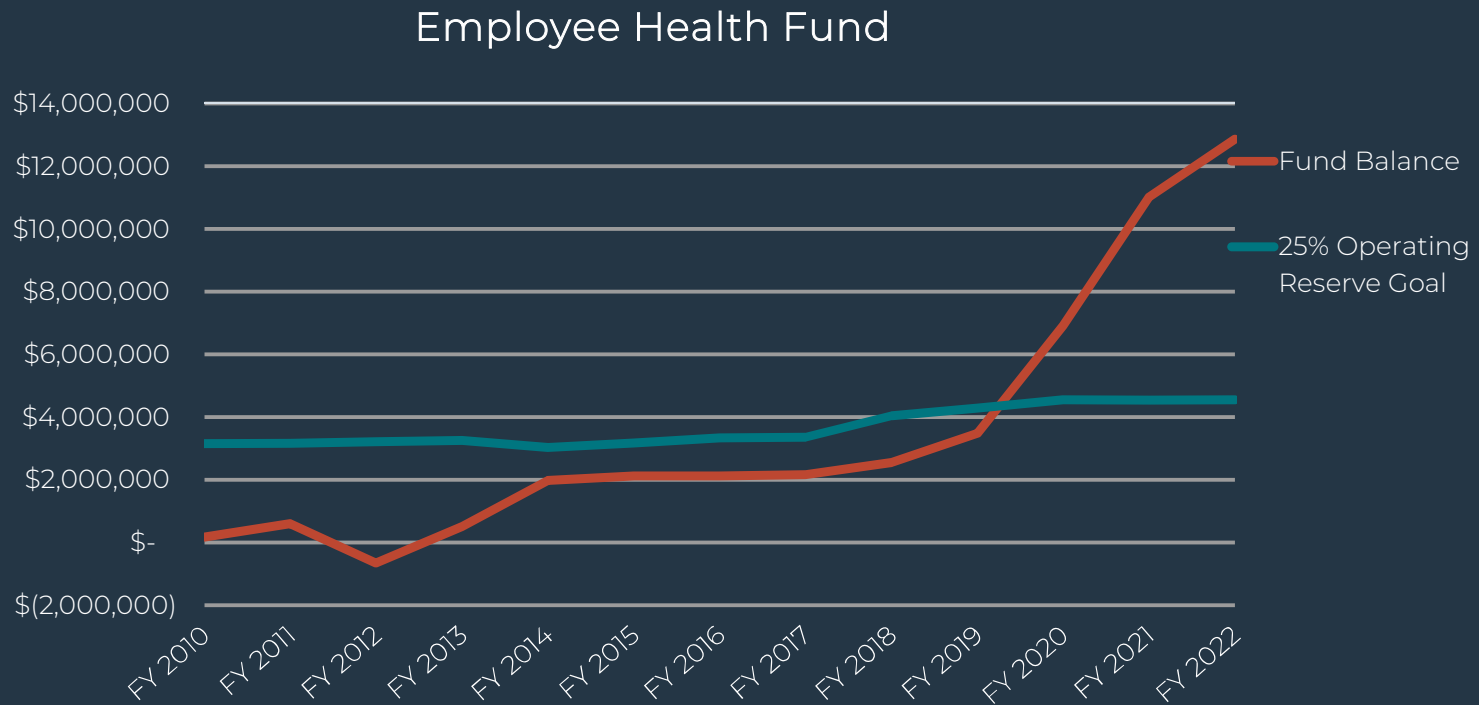

Maintains the current tax levy rate of \$16.78/\$1,000 taxable valuations and current service levels.

# FY 2024 BUDGET

	Adopted FY 2023	Proposed FY 2024	Change
Operating	\$154,642,620	\$161,164,061	+4.2%
Capital	\$45,592,594	\$49,575,881	+8.7%
Debt	\$35,877,850	\$31,802,176	-11.4%
Total	\$236,113,064	\$242,542,118	+2.7%

# PROPERTY TAXES ROLLBACK AMOUNTS



Property Class	FY 2023	FY 2024
Agricultural	89.0412%	91.6430%
Residential	54.1302%	56.4919%
Commercial/ Industrial	90%	90%*
Multi-Residential	63.75%	56.4919%

# 100% VALUATION

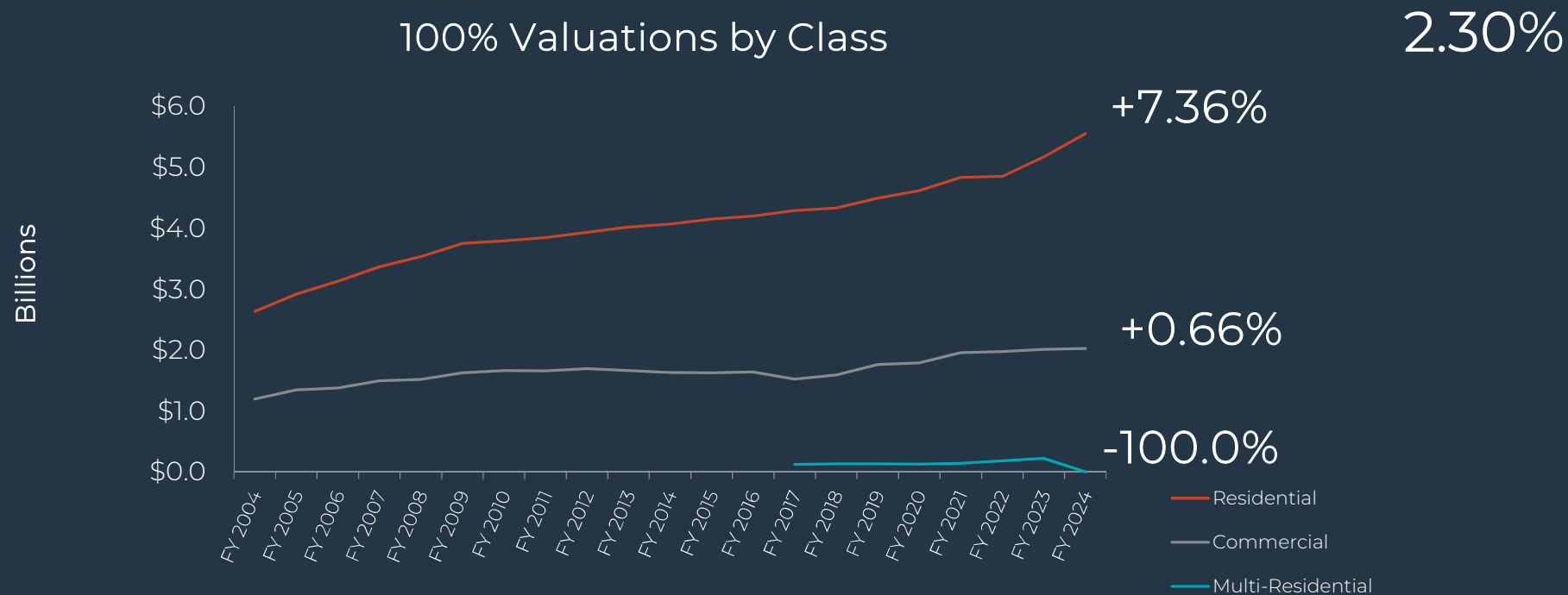



# BUSINESS PROPERTY TAX CREDIT



## Business Property Tax Credit Modifications Impact

Classification	# of Parcels	Total Value	Percent
Received BPTC in 2021	2,369	\$1,919,792,836	80.07%
Single Parcel (No BPTC)	468	\$321,201,072	13.40%
Multi-Parcel No BPTC	256	\$156,616,846	6.53%
Total	3,093	\$2,397,610,754	100.00%

- 1) 724 additional properties will begin receiving this credit for FY 2024 (roughly 20% of total parcels).
- 2) City receives a backfill payment from the State (\$1.7M anticipated in FY 2024 – all funds).
- 3) FY 2024 Budget includes strategic budget reduction to decrease reliance on these funds.

# TAXABLE VALUATION

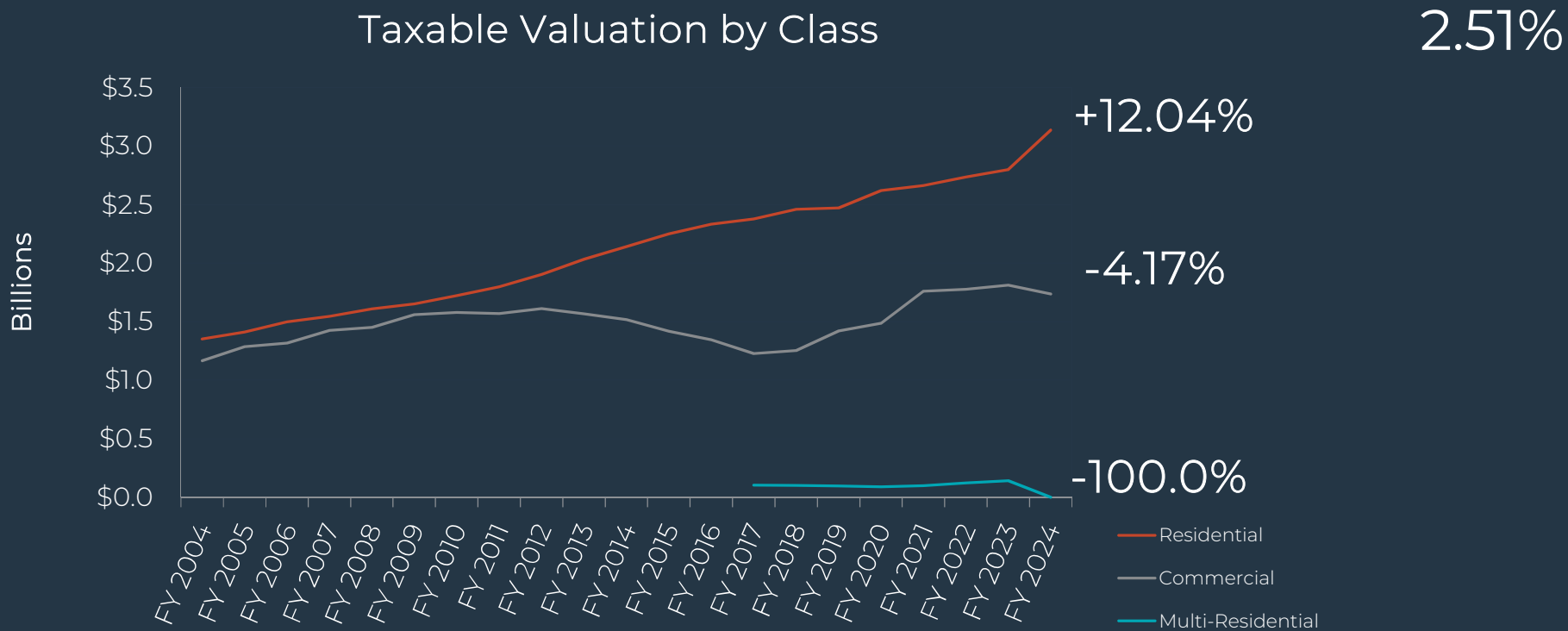

# FY 2024 BUDGET

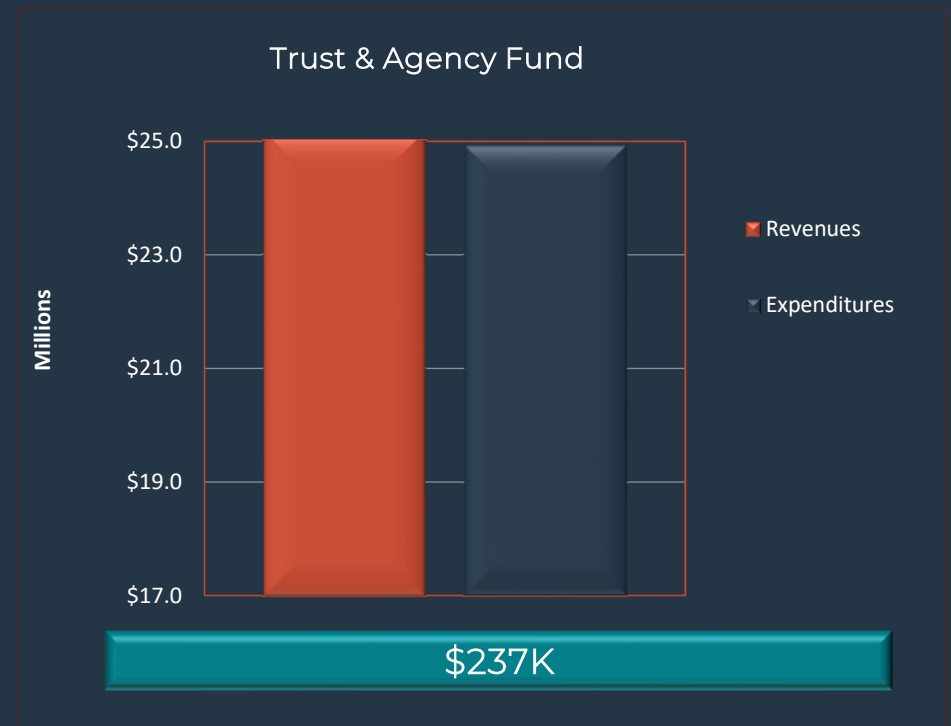

# FY 2024 BUDGET



## General Fund Revenues

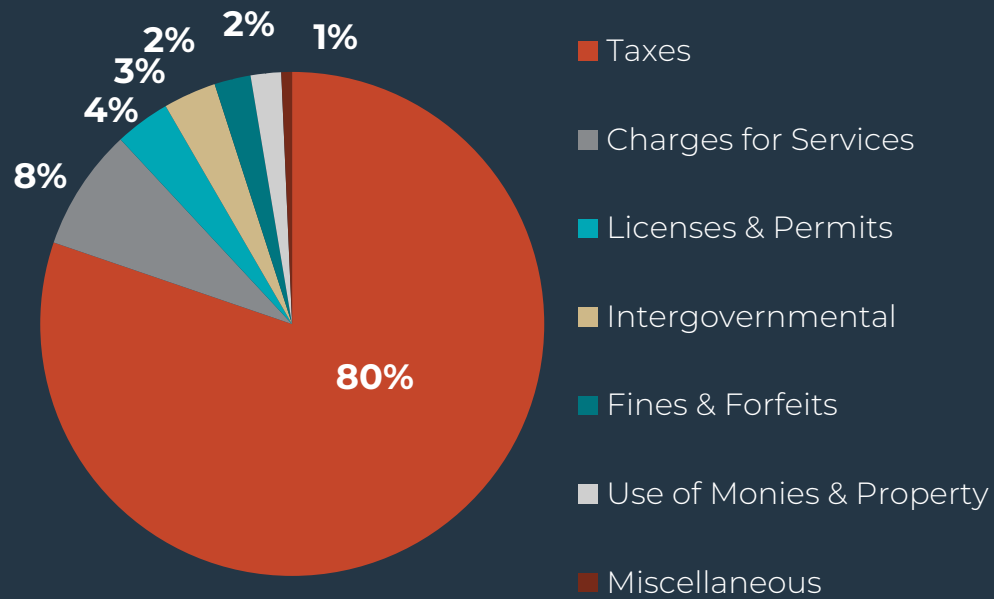

## General Fund Expenditures

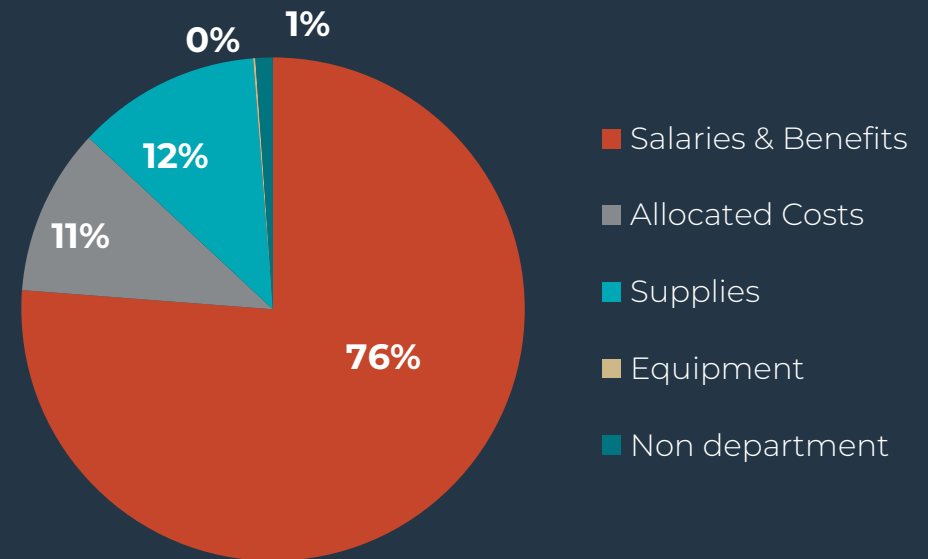

# FY 2024 BUDGET

General Fund and Trust & Agency  
Fund Revenues

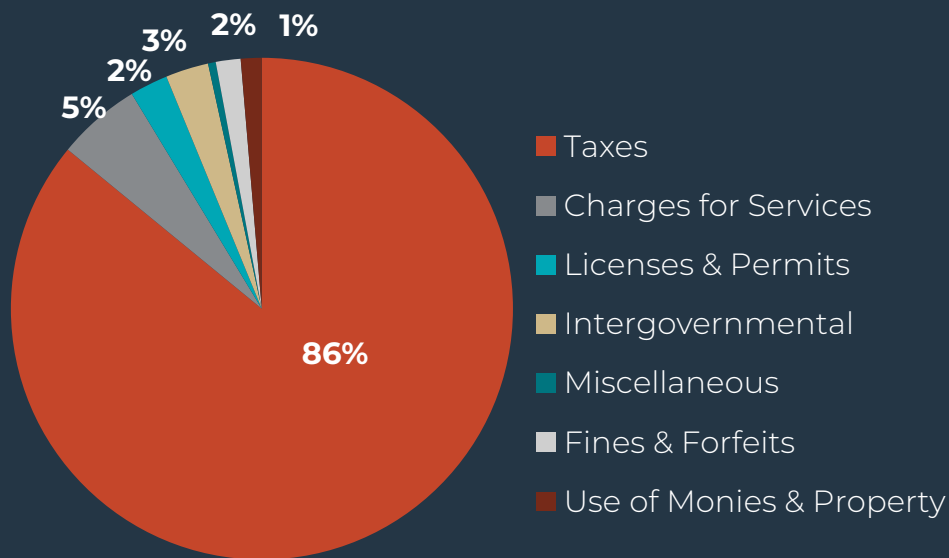

General Fund and Trust & Agency  
Fund Expenditures

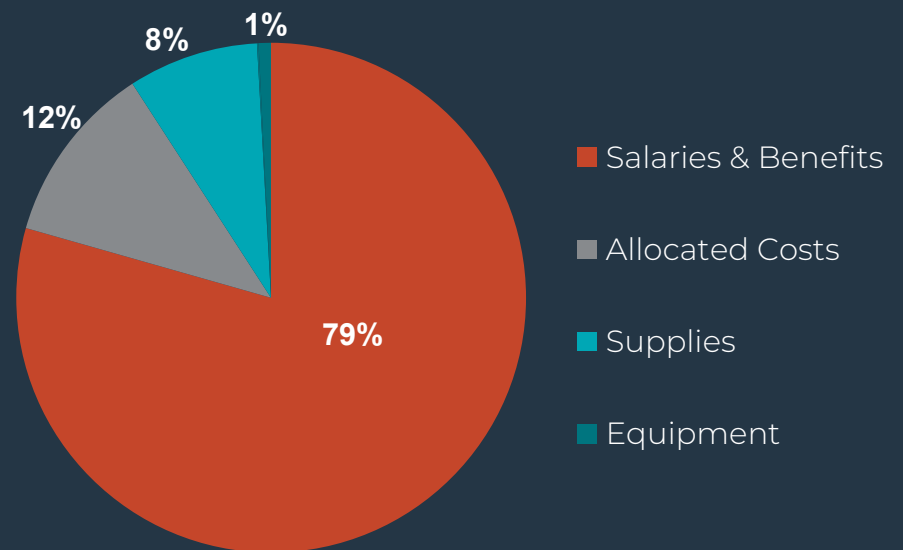

# FY 2024 PUBLIC SAFETY



General Fund, Trust & Agency Fund,  
Special Public Safety Fund

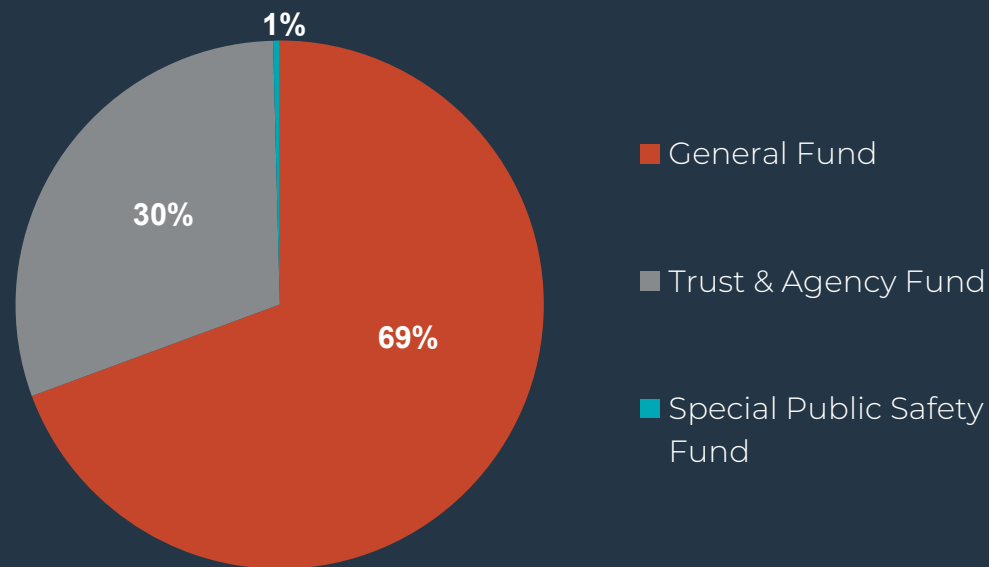



# FY 2024 BUDGET

## General Fund & Trust & Agency Fund



	Adopted FY 2023	Proposed FY 2024	Change
Salaries & Benefits	\$63,620,100	\$65,942,956	+3.65%
Supplies	\$6,575,254	\$6,856,955	+4.28%
Equipment	\$77,500	\$82,500	+6.45%
Allocated Costs	\$8,920,977	\$9,495,786	+6.44%
Non- Departmental	\$650,793	\$654,719	+0.60%
Total	\$79,844,624	\$83,032,916	+3.99%

# HOTEL/MOTEL TAX FUND



Most impacted fund due to COVID-19; adjustments made to FY 2020 & FY 2021 Budgets; maintaining these decreases and increased monitoring for FY 2022 had positive outcome.

Increased FY 2022 fund balance by \$1,036,665. Impacts have been fully mitigated.

Current forecasts show revenues trending in line with budget (\$2.5M).

Assuming trend holds in FY 2023 & FY 2024, prior adjustments may be restored to continue RiverCenter investment initiatives.

# FY 2024 BUDGET HOTEL/MOTEL TAX FUND



Hotel/Motel Tax Fund Revenue

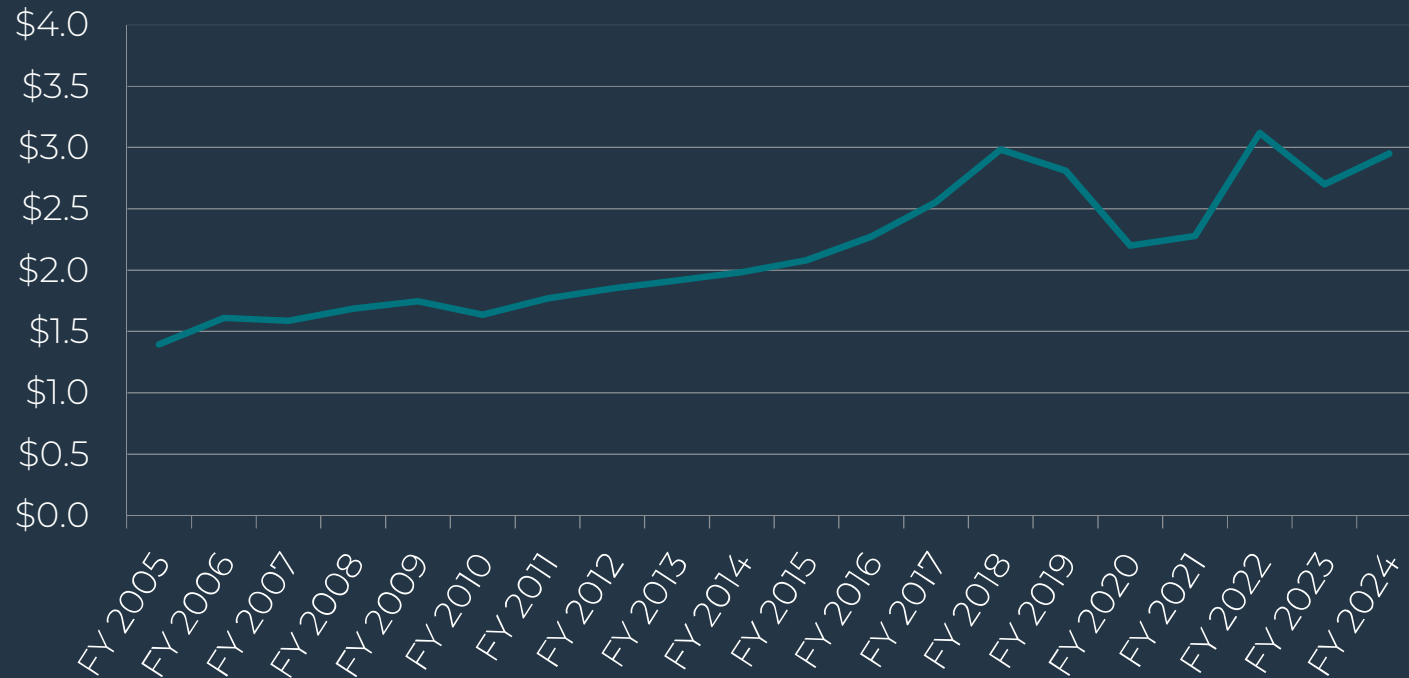

# ENTERPRISE FUNDS



Enterprise funds operate as business-type funds (proprietary funds). The City currently has 11 enterprise funds.

Measurement goal is focused on sufficient cost-recovery and having adequate reserves; not profit.

Deficits within these funds can create operational burdens on other funds (transfers/reductions required).

Continued emphasis on prior and current Council direction to apply modest and consistent revenue escalators to cover ongoing increases in operational expenses (inflation, contract escalations, equipment, & capital needs).

# SEWER FUND



Recently completed a comprehensive sewer rate study (PFM) and recommendations were presented to the City Council in November 2021.

5.0% recommended annual increases (FY 2023 – FY 2025).

Focus on continuing to increase available cash to address long-term capital needs in sewer system and at the Water Pollution Control Plant, while applying innovative financing strategies to eliminate long-term debt.

# SEWER & WPCP FUNDS

The Joint Use Cities developed a new 28E agreement to jointly own, use, maintain, and improve certain interceptor sewers, the water pollution control plant, and the compost facility.



The new agreement establishes a new funding model with the following funds:

- Water Pollution Control Plant (Operations)
- Water Pollution Control Plant Equipment Replacement (15%)
- Water Pollution Control Plant Reserve (2%)
- Water Pollution Control Plant Debt (As necessary)



This agreement was approved by the City Council on November 26, 2019 and has been in place since 2020.



# FY 2024 BUDGET SEWER FUND | CASH



Sewer Fund Cash Balance

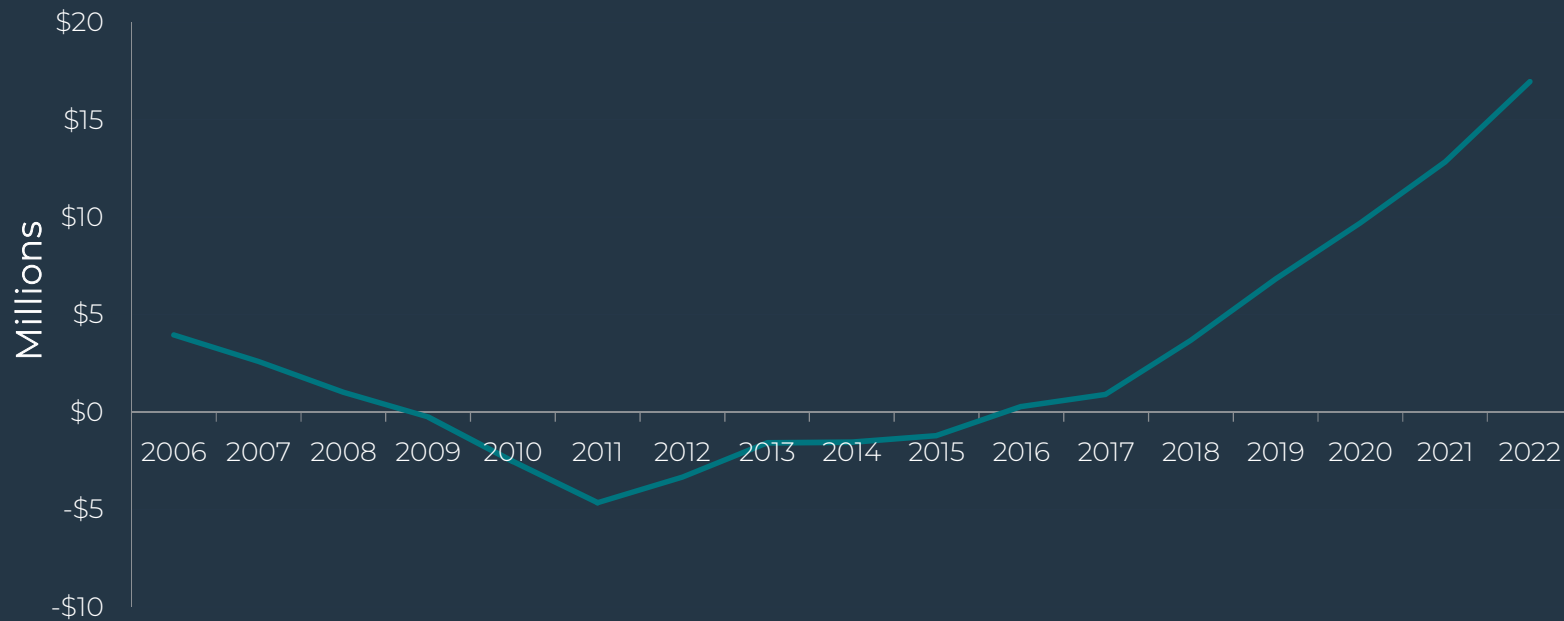

# SEWER RATE CHANGES



	CURRENT FY 2023	FY 2024	FY 2025	FY 2026
Quarterly Customer Charge	\$29.87	\$31.34	\$32.88	\$34.52
Volume Rate per CCF	\$5.72	\$6.01	\$6.31	\$6.63
Monthly Increase*	(\$6.85)	\$2.81	\$2.91	\$3.21
Quarterly Increase*	\$3.56	\$3.79	\$3.94	\$4.20

5% annual increase adopted for FY 2023 – FY 2025

\*Average Residential Customer at 8 CCFs

# NO FAULT SEWER REIMBURSEMENT



	FY 2015	FY 2016	FY 2017	FY 2018	FY 2019	FY 2020	FY 2021	FY 2022
Revenue	\$265,715	\$296,456	\$292,155	\$250,230	\$58,982	\$61,949	\$66,118	\$64,158
Expense	\$80,359	\$253,287	\$155,316	\$24,993	\$71,598	\$87,144	\$27,136	\$62,132
Quarterly Rate	\$2.00	\$2.00	\$2.00	\$2.00	\$0.50	\$0.50	\$0.50	\$0.50
Claims	23	132	15	16	26	10	12	10
Average Cost	\$3,494	\$1,919	\$10,354	\$2,674	\$4,411	\$2,576	\$2,497	\$5,053
Net	\$185,356	\$43,169	\$136,839	\$225,237	\$(12,616)	\$(25,195)	\$38,982	\$2,026
Available Program Balance	\$185,970	\$229,139	\$365,978	\$591,215	\$578,599	\$553,404	\$592,386	\$594,412

# SOLID WASTE FUND CASH BALANCE



Solid Waste Fund Cash Balance

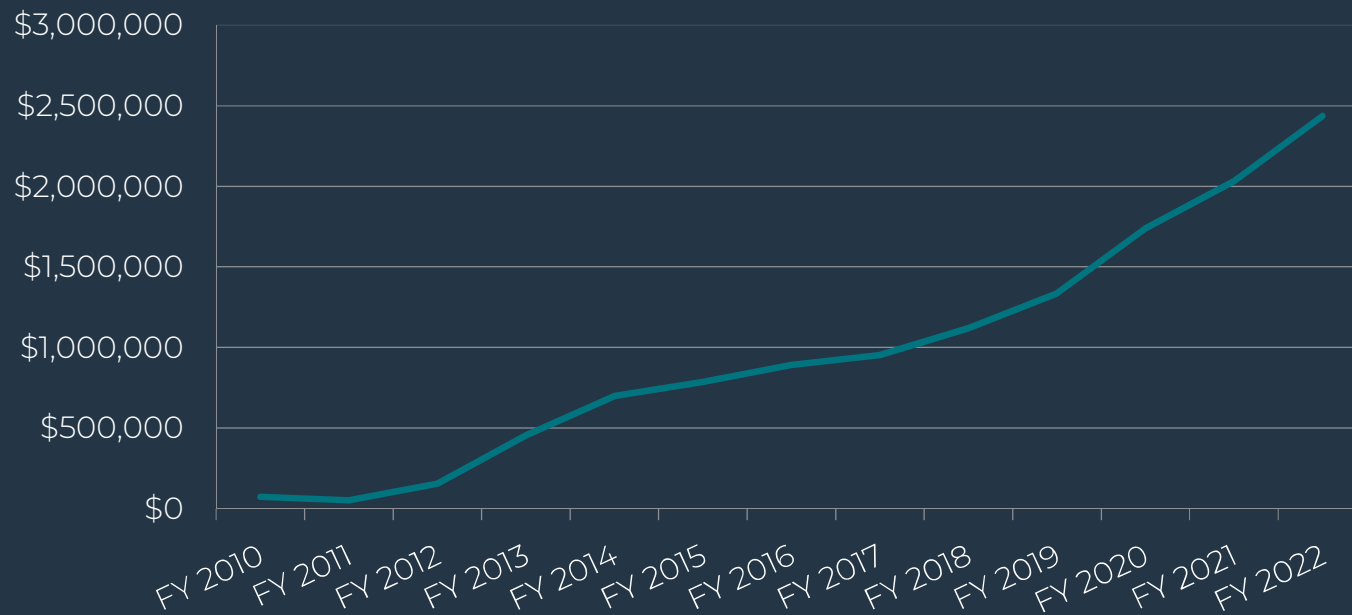



# SOLID WASTE FUND OPERATIONS



Route Study Completed in CY 2022 | Resulted in 798 stops moved from Monday to Tuesday to balance work load/help limit overtime expenses within the fund.

Proposed budget/personnel increase of one Packer/Driver/Loader.

- Assist with increasing demand for environmental clean-ups.
- Assist with increasing demand for the City's bulk waste and special pick-up programs.

FY 2024 Solid Waste Fund anticipated surplus | \$180,732.

- Sufficient to continue to slightly grow cash while meeting operating demands of enterprise fund.

# SOLID WASTE FUND

## FEES PER MONTH



	Rate		Rate		Rate	
FY 2023 →	\$14.22	\$0.41	\$18.13	\$0.53	\$22.06	\$0.64
FY 2024 →	\$14.65	\$0.43	\$18.67	\$0.54	\$22.72	\$0.66
FY 2025 →	\$15.09	\$0.44	\$19.23	\$0.56	\$23.41	\$0.69

*3% annual increases*

# CLEAN WATER FUND CASH BALANCE

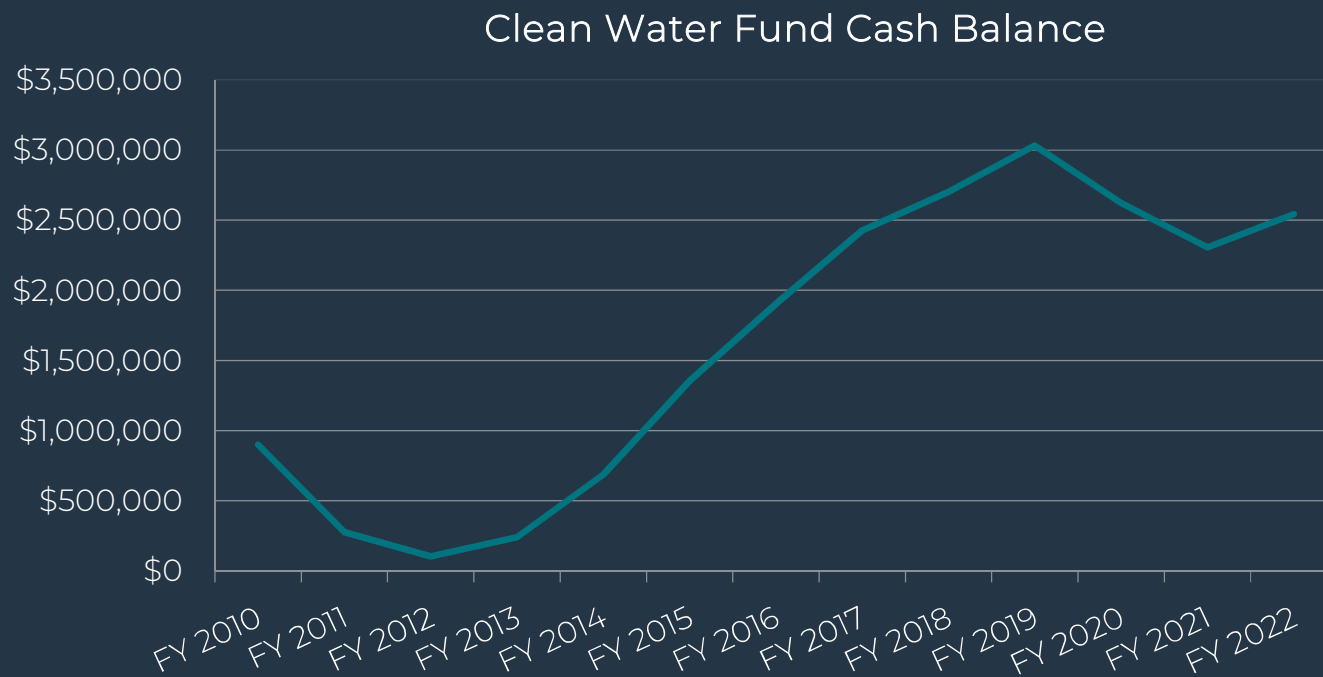

# CLEAN WATER FUND

## ERU RESIDENTIAL FEE



	Rate per Month	Increase
FY 2023	\$3.06	\$0.09
FY 2024	\$3.15	\$0.09
FY 2025	\$3.25	\$0.10

3% annual increases



# ENTERPRISE PLANNING



## PARKING FUND | FY 2024 proposed deficit of \$30,827

- Parking ramp debt was completely paid off in FY 2021.
- The priority of this fund will now be shifted to enterprise planning including the ongoing maintenance and security of the ramps.

## RIVER'S EDGE FUND | FY 2024 proposed deficit of \$303,469

- This fund receives transfers from the General Fund and Hotel/Motel Tax Fund in order to subsidize expenses (\$225,000).
- The priority of this fund will now be shifted to enterprise planning including the evaluation of operations and programming.
- Council recommendation in Q2 2023.

# TRANSIT FUND



	FY 2015	FY 2016	FY 2017	FY 2018	FY 2019	FY 2020	FY 2021	FY 2022
Operating Revenues								
Rider Fees	\$494,410	\$899,113	\$422,570	\$413,710	\$455,774	\$316,547	\$289,486	\$378,632
Property Taxes	\$3,602,973	\$3,574,407	\$3,576,836	\$3,667,870	\$3,851,795	\$3,992,658	\$4,318,477	\$4,303,719
Grants	\$2,172,106	\$2,083,842	\$2,047,183	\$1,880,753	\$2,262,548	\$3,215,623	\$4,711,231	\$4,002,823
Other	\$(384,790)	\$(19,661)	\$18,038	\$16,800	\$18,025	\$12,439	\$10,465	\$31,869
Operating Expenditures								
Employee Expenses	\$3,038,146	\$3,316,875	\$3,400,345	\$3,382,692	\$3,827,483	\$4,240,604	\$4,021,355	\$3,760,726
Supplies & Services	\$3,205,018	\$2,906,463	\$2,918,360	\$2,995,600	\$3,198,268	\$2,853,584	\$2,784,890	\$2,980,315
City Cash Subsidy	\$0*	\$0*	\$107,591	\$500,000	\$413,385	\$0	\$0	\$0

Does not include depreciation

\*Prior to FY 2017 the City did not subsidize the fund and it was allowed to be in a negative cash status

# TRANSIT FUND

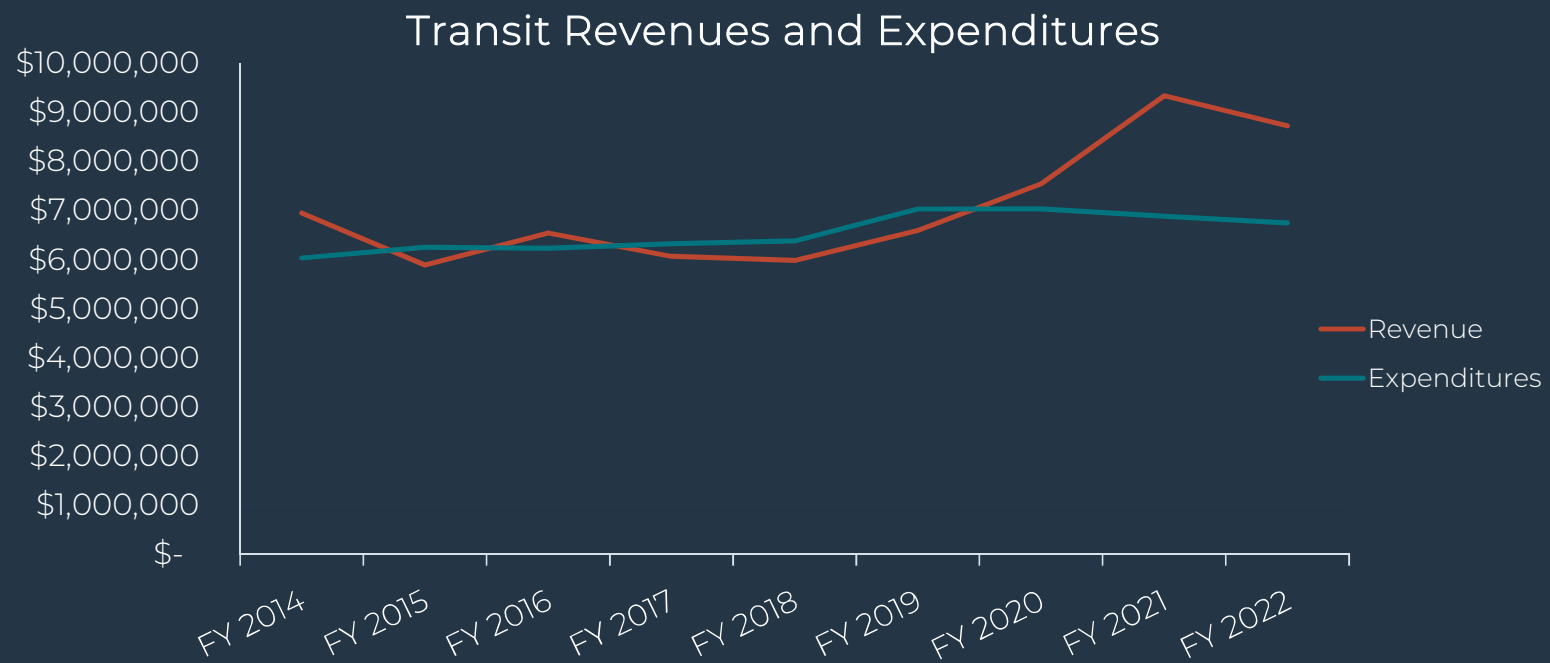

\*Does not include depreciation

# FY 2024 BUDGET HIGHLIGHTS



1

Remains mission-aligned and continues the focus on operational pillars, ARPA, and the City Administrator's workplan.

2

Complies with the City Council's policies for all reserve and liquidity targets & financial policies.

3

Maintains the current tax levy rate of \$16.78/\$1,000 taxable value and current service levels.

# WHAT'S NEXT



1

Capital Introduction

2

Road Use Tax Fund

3

Local Sales Tax Fund

4

Debt Service Fund

5

CY 2023 Infrastructure Investment

6

FY 2024 Capital Improvement Plan



---

# THANK YOU

---

